

Date 7/4/81 Rec. Doolittle/McCary Long. 110° 09' 40" W Lat. 29° 43' 45" N Temporal No. A12-T2

Locale Arroyo Rancho / Baviácora User Jesus Montaña / Neco Tanzi Cultivated Area (ha) 1.85

Features	Description (quantitative and qualitative)	Volume (m ³)
Fence	4 wire, old 10 posts / 14 meters	537m 2,148 meters 384 posts
Weir	18 meter medium construction, 12 "Y" branches each supporting 4-5 smaller branches. Anchored with large rocks and sandbags, covered with earth from canal.	
Canal	15m: X-sec weir "A"; 102m: X-sec weir "B", 80m to Ø X-sec.	211.47m ³
Ditches	120m hoed-ditch	37.5m ³
Bunds	150m long (see x-section)	
Water Spreader	None	
Terraces	None	
Leveling	None	

Other Field is newer than T3 by fence-corner evidence. At one time this temporal was much larger than present. The lower 2/3 have been brought under well-irrigation, leaving only this field as temporal. Other Sketch maps and X-section on reverse side. fields designated "I".

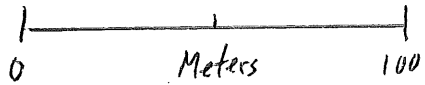
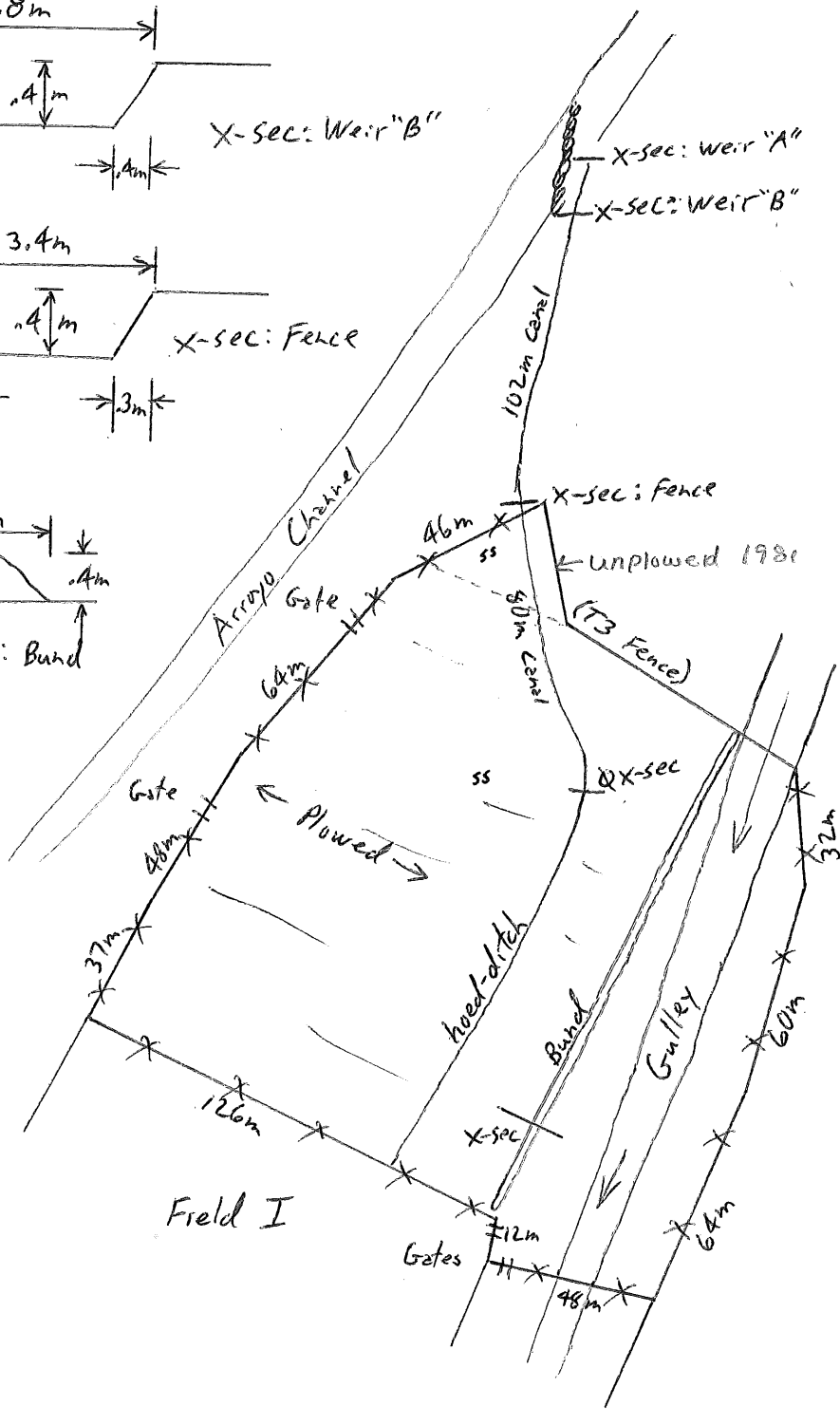
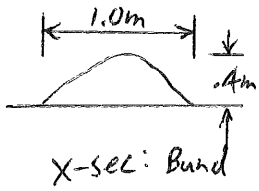
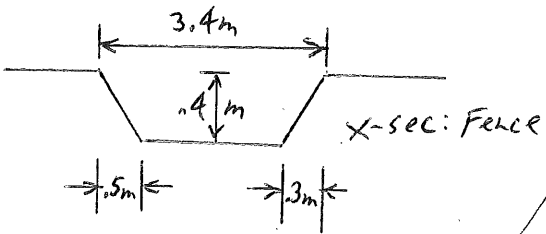
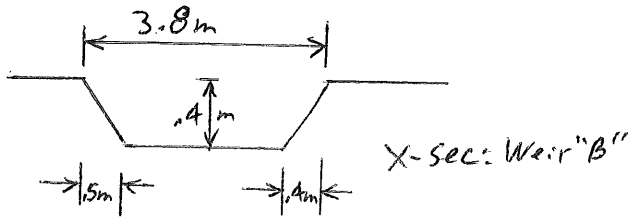
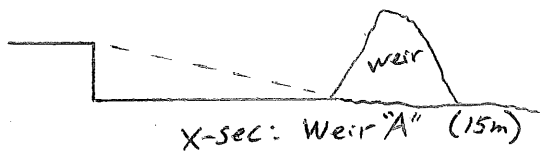

3.4 sq. rh = 1/2
 7.2 Sq. rh